

Imani's office is 10 ft long and 8 ft wide. Jazmine is planning an office that is 3 ft longer and 3 ft wider than Imani's.

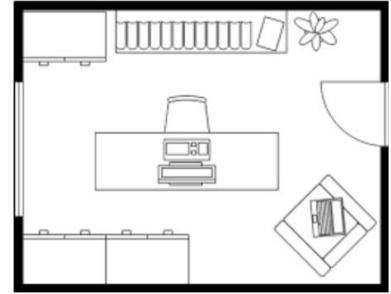

1. **Draw** Jazmine's office so that you can see:
 - Imani's room in the drawing
 - How much more area Jazmine's office has than Imani's

2. Mauricio and Emily initially predicted that the area of Jazmine's office was **9 ft²** bigger than Imani's office.
 - A. **Circle and label** where you see 9 ft² in your drawing from Question 1.

 - B. **Explain why** increasing both the length and width of Imani's office by 3 feet increases the area so much more than 9 ft².

